

Extra Large Outdoor Enclosed Poster Cases with Header and Lights (XL Single Door Swing Case)

FOR CURRENT PRICING, VISIT THE ID # LISTED ABOVE

Product Details

- **Extra Large Outdoor Poster Display Case**
- Poster Case with Your Personalized Message Header
- Illuminated Poster Display Case
- **Weather Resistant and Made for the Outdoors**
- Durable Aluminum Cabinet Construction
- Mitered Corners Display Box
- **Enclosed Bulletin Board**
- 5" High White Message Header Panel
- Your Personalized TEXT Message **Printed Free**
- Text Message Printed up to 3" high ALL CAPS Black Helvetica Font
- Interior Lighted Poster Case
- Wall Mount, XL Single Door
- Extra Large Clear Viewing Window
- Cabinet Features full length piano hinge (opens right to left)
- Locking Poster Display Case
- Security cam-lock on front of frame door (2 keys included)
- Overall Case Depth: **3 1/8"**
- Interior Useable Depth: **1 5/8"**
- **4** outdoor treated frame finishes
- Break Resistant Acrylic: Perfect for high traffic or public locations
- Natural Tan Cork Interior Panel
- Withstands typical everyday outside elements -Not floodproof
- **Bottom Cabinet Weep Holes** help drain any water
- Vents help dissipate and reduce any condensation buildup
- Weather resistant aluminum backing with silicone sealant
- XL Display Case must be **surface mounted** on the wall
- **Free Shipping** on Extra Large Poster Display Cases Single Door
- **Call for Custom Outdoor Poster Cases**

Header Details

- UPPERCASE Helvetica vinyl lettering
- **Black lettering on a 5" white header (3" max text height)**
- Please type your message in the text box provided below, we will try to keep your message on one line unless otherwise specified. If we can't fit your message on one line we will center your copy on two lines. For the customer that needs a specific font, color or text positioning, you may call customer service with your requests.

SELECT THE RIGHT OPTION FOR YOU. AND FOLLOW INSTRUCTIONS

STANDARD HEADER (No Charge)

- Standard UPPERCASE Black Helvetica Lettering as detailed above.
- Make sure to spell out your header in the empty **Text Box** above the Green ADD to CART button. Check your grammar & spelling!

LEAVE HEADER BLANK (No Charge)

- For those customers that will be adding their own header, select this option. Make sure to enter **LEAVE BLANK** in the empty **Text Box** above the Green ADD to CART button.

CUSTOM HEADER / LOGO (Upcharge)

- This is for or those customers that wish to send us a specific FONT, COLOR, or LOGO. Make sure to enter **CUSTOM LOGO** in the empty **Text Box** above the Green ADD to CART button. We will contact you once the order has been received to instruct you on how to submit the Hi-Res EPS File to us.

Lighting Information

- Top Lighting - an LED strip is placed across the top and shines downward
- UL approved LED Strip Lighting
- Cool White LED Lighting
- LED Life: 50,000 hours
- We provide a 3-wire cord attached to the ballast / transformer inside the display case.
- When installing you should use a licensed electrician / installer to bring power to the display. The installer will best decide where to exit the hardwire provided (we do not provide an exit hole as we feel its best for the installer to decide the best exit point for power supply).

Ordering Options

- Vinyl covering over cork
- Frame Orientation: Portrait or Landscape

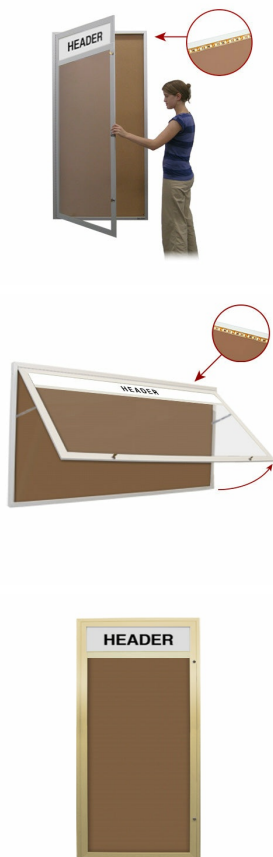

Door Window: Break Resistant or Tempered Glass

- Break Resistant Acrylic: 1/4" thick, lightweight (Standard)
- Tempered Glass: 1/4" Tempered Glass is offered for public environments which require this added safety standard. (Upcharge)

Landscape Orientation Information

*For outdoor poster cases being built for landscape orientation, the following information below will apply.

- The hinge placement will always be on Top (**Door Swings Upward**)
- Prop arms will be added to the unit to support and hold the door.
- The prop arms will extend the door open at approximately 45 degrees.

Model	Overall Size	Viewable Area (Portrait)	Viewable Area (Landscape)	Interior Size (Portrait)	Interior Size (Landscape)	Ships Via	Shipping Weight
SCPXLHL-2448	24" x 48" x 3 1/8"	17 3/4" x 35 1/2"	42" x 11 1/4"	19" x 37 1/4"	43 1/4" x 13"	Freight	27
SCPXLHL-2460	24" x 60" x 3 1/8"	17 3/4" x 47 1/2"	54" x 11 1/4"	19" x 49 1/4"	55 1/4" x 13"	Freight	31
SCPXLHL-2472	24" x 72" x 3 1/8"	17 3/4" x 59 1/2"	66" x 11 1/4"	19" x 61 1/4"	67 1/4" x 13"	Freight	37
SCPXLHL-2484	24" x 84" x 3 1/8"	17 3/4" x 71 1/2"	78" x 11 1/4"	19" x 73 1/4"	79 1/4" x 13"	Freight	52
SCPXLHL-2496	24" x 96" x 3 1/8"	17 3/4" x 83 1/2"	90" x 11 1/4"	19" x 85 1/4"	91 1/4" x 13"	Freight	56
SCPXLHL-3648	36" x 48" x 3 1/8"	29 3/4" x 35 1/2"	42" x 23 1/4"	31" x 37 1/4"	43 1/4" x 25"	Freight	31
SCPXLHL-3660	36" x 60" x 3 1/8"	29 3/4" x 47 1/2"	54" x 23 1/4"	31" x 49 1/4"	55 1/4" x 25"	Freight	44
SCPXLHL-3672	36" x 72" x 3 1/8"	29 3/4" x 59 1/2"	66" x 23 1/4"	31" x 61 1/4"	67 1/4" x 25"	Freight	54
SCPXLHL-3684	36" x 84" x 3 1/8"	29 3/4" x 71 1/2"	78" x 23 1/4"	31" x 73 1/4"	79 1/4" x 25"	Freight	63
SCPXLHL-3696	36" x 96" x 3 1/8"	29 3/4" x 83 1/2"	90" x 23 1/4"	31" x 85 1/4"	91 1/4" x 25"	Freight	67
SCPXLHL-4060	40" x 60" x 3 1/8"	33 3/4" x 47 1/2"	54" x 27 1/4"	42" x 49 1/4"	55 1/4" x 29"	Freight	48
SCPXLHL-4848	48" x 48" x 3 1/8"	41 3/4" x 35 1/2"	N/A	43" x 37 1/4"	N/A	Freight	49
SCPXLHL-4860	48" x 60" x 3 1/8"	41 3/4" x 47 1/2"	54" x 36 1/4"	43" x 49 1/4"	55 1/4" x 38"	Freight	57
SCPXLHL-4872	48" x 72" x 3 1/8"	41 3/4" x 59 1/2"	66" x 36 1/4"	43" x 61 1/4"	67 1/4" x 38"	Freight	65
SCPXLHL-4884	48" x 84" x 3 1/8"	41 3/4" x 71 1/2"	78" x 36 1/4"	43" x 73 1/4"	79 1/4" x 38"	Freight	77
SCPXLHL-4896	48" x 96" x 3 1/8"	41 3/4" x 83 1/2"	90" x 36 1/4"	43" x 85 1/4"	91 1/4" x 38"	Freight	87