

SwingSnap Extra Large Poster Snap Frames with Security Screws to Hold 1/8", 3/16", and 1/4" Thick Graphic Boards in 25 Sizes

FOR CURRENT PRICING, VISIT THE ID # LISTED ABOVE
FREE SHIPPING

Product Details

*ALL 4 FRAME SIDES HAVE A SECURITY SCREW PLACED INTO THE CENTER OF EACH FRAME RAIL. THESE SCREWS SECURE THE SAFETY OF YOUR POSTING AND PREVENT ANY TAMPERING.

- X Large Security Snap Frames for Mounted Graphics
- For Posters and Signs on Rigid Boards
- Accepts 1/8, 3/16", 1/4" Thick Boards
- Allen Wrench Tool with Security Screws Included
- Quick-Changing, all 4 frame rails snap-open with Tool
- Front Loading Frame for posters and other signage
- Snap Frame Profile: **1 1/4" Wide**
- Narrow profile offers an 11/16" overall off the-wall depth
- Accepts printed material up to 1/4" thick
- Viewable Area: Moulding overlaps poster insert by 3/8" all around
- (9) Aluminum snap frame
- .040 Backing Board: If needed, provides rigidity for a thin poster board
- .020 clear PETG overlay included protecting poster insert
- **Allen Wrench Tool:** included to help remove and secure your inserts
- SwingSnap poster frames mount Portrait or Landscape
- Installs Easily: Punched holes in frame for easy surface mounting
- Wall Mount Hardware (screws) Included
- Call for Custom Snap Frame Sizes Large and Small

XL Security Snap Frame 48x48 Ship UNASSEMBLED

- Aluminum snap-open displays are for **INDOOR** or ****OUTDOOR** use

****Make sure you laminate your insert material if going outdoors**
****Poster Snap Frames are weather resistant, not water-proof**
XL Security Snap Frame 48x48 Ship UNASSEMBLED

Ships Unassembled

- ALL snap frame sizes are cut to size, and prepped for easy assembly
- Takes minutes to assemble, Corner Key and Mounting Hardware Included
- Backing Board is rolled up and placed into box for shipping cost savings
- Clear Overlay is rolled up and placed into box for shipping cost savings

.....

- ALL snap frame rail sizes 85" and larger will be **CUT in HALF** and

provided with a Straight Joiner Key to connect the two snap frame rails together.

This will create a seam in your snap frame rail where 2 or more pieces on one side of your frame will flip open.

The main reason for creating the seam is to reduce shipping costs. We will ship these chopped snap frame rails via common carrier ground service.

Each Frame Rail that is **CUT in HALF** will receive a **CENTERED** security screw

- We will ship any Length up to 144" in **FULL LENGTH** via Freight Carrier.

Please call us for your oversized snap frame dimensions to provide frame & freight costs

.....

For Detailed Instructions on How to Assemble click

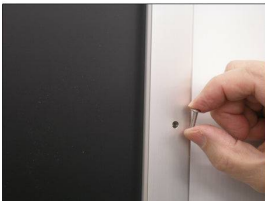
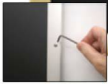

on the Instruction Sheet ICON up above.

Mounted Graphic Details

1/8" Mounted Graphic Insert

All frames will include a .040 Black Backer Board

All frames will include a .020 Clear Overlay

3/16" Mounted Graphic Insert

All frames will include a .040 Black Backer Board

All frames will include a .020 Clear Overlay

1/4" MAX Mounted Graphic Insert

.040 Black Backer Board **NOT INCLUDED** (can not fit)

.020 Clear Overlay **NOT INCLUDED** (can not fit)

Custom Sizes & Shipping Options Available

- Call to **Customize XL Mounted Poster Tamper Proof Snap Frames!**
- If you request a Snap Frame to be FULLY ASSEMBLED,

please call for a shipping quote.

- Call us to quote out snap frames sizes up to 144" x 144" (12 FEET x 12 FEET)

[About SwingSnap Snap Frames:](#)

[Easy Assembly Instructions:](#)

Model	Insert Size	Overall Size	Viewable Area	Ships Via	Shipping Wt	How is Frame Shipped?
SSMCSSXLMT-2460	24" x 60"	25 3/4" x 61 3/4"	23 1/4" x 59 1/4"	UPS	18	Unassembled
SSMCSSXLMT-2472	24" x 72"	25 3/4" x 73 3/4"	23 1/4" x 71 1/4"	UPS	21	Unassembled
SSMCSSXLMT-2484	24" x 84"	25 3/4" x 85 3/4"	23 1/4" x 83 1/4"	UPS	26	Unassembled

SSMCSSXLMT-2496	24" x 96"	25 3/4" x 97 3/4"	23 1/4" x 95 1/4"	UPS	30	Unassembled
SSMCSSXLMT-3660	36" x 60"	37 3/4" x 61 3/4"	35 1/4" x 59 1/4"	UPS	21	Unassembled
SSMCSSXLMT-3672	36" x 72"	37 3/4" x 73 3/4"	35 1/4" x 71 1/4"	UPS	26	Unassembled
SSMCSSXLMT-3684	36" x 84"	37 3/4" x 85 3/4"	35 1/4" x 83 1/4"	UPS	30	Unassembled
SSMCSSXLMT-3696	36" x 96"	37 3/4" x 97 3/4"	35 1/4" x 95 1/4"	UPS	34	Unassembled
SSMCSSXLMT-4050	40" x 50"	41 3/4" x 51 3/4"	39 1/4" x 39 1/4"	UPS	26	Unassembled
SSMCSSXLMT-4060	40" x 60"	41 3/4" x 61 3/4"	39 1/4" x 59 1/4"	UPS	22	Unassembled
SSMCSSXLMT-4242	42" x 42"	43 3/4" x 43 3/4"	41 1/4" x 41 1/4"	UPS	21	Unassembled
SSMCSSXLMT-4848	48" x 48"	49 3/4" x 49 3/4"	47 1/4" x 47 1/4"	UPS	21	Unassembled
SSMCSSXLMT-4860	48" x 60"	49 3/4" x 61 3/4"	47 1/4" x 59 1/4"	UPS	26	Unassembled
SSMCSSXLMT-4872	48" x 72"	49 3/4" x 73 3/4"	47 1/4" x 71 1/4"	UPS	30	Unassembled
SSMCSSXLMT-4884	48" x 84"	49 3/4" x 85 3/4"	47 1/4" x 83 1/4"	UPS	34	Unassembled
SSMCSSXLMT-4896	48" x 96"	49 3/4" x 97 3/4"	47 1/4" x 95 1/4"	UPS	38	Unassembled
SSMCSSXLMT-6060	60" x 60"	61 3/4" x 61 3/4"	59 1/4" x 59 1/4"	UPS	30	Unassembled
SSMCSSXLMT-6072	60" x 72"	61 3/4" x 73 3/4"	59 1/4" x 71 1/4"	UPS	34	Unassembled
SSMCSSXLMT-6084	60" x 84"	61 3/4" x 85 3/4"	59 1/4" x 83 1/4"	UPS	34	Unassembled
SSMCSSXLMT-6096	60" x 96"	61 3/4" x 97 3/4"	59 1/4" x 95 1/4"	UPS	34	Unassembled
SSMCSSXLMT-7272	72" x 72"	73 3/4" x 73 3/4"	71 1/4" x 71 1/4"	UPS	38	Unassembled
SSMCSSXLMT-7284	72" x 84"	73 3/4" x 85 3/4"	71 1/4" x 83 1/4"	UPS	40	Unassembled
SSMCSSXLMT-7296	72" x 96"	73 3/4" x 97 3/4"	71 1/4" x 95 1/4"	UPS	40	Unassembled
SSMCSSXLMT-8496	84" x 96"	85 3/4" x 97 3/4"	83 1/4" x 95 1/4"	UPS	43	Unassembled
SSMCSSXLMT-9696	96" x 96"	97 3/4" x 97 3/4"	95 1/4" x 95 1/4"	UPS	48	Unassembled