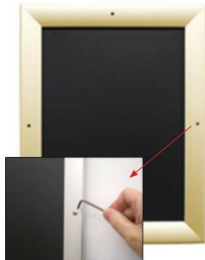

EXTRA LARGE - EXTRA DEEP 24x60 Poster Snap Frames with Security Screws (for MOUNTED GRAPHICS)

FOR CURRENT PRICING, VISIT THE ID # LISTED ABOVE
FREE SHIPPING

Product Details

***ALL 4 FRAME SIDES HAVE A SECURITY SCREW PLACED INTO THE CENTER OF EACH FRAME RAIL. THESE SCREWS SECURE THE SAFETY OF YOUR 24 x 60 POSTING AND PREVENT ANY TAMPERING.**

- Security Snap Frames
- Security Locking Screws with Key Tool
- Extra Large, Extra Deep Snap Poster Frame
- Extra Large Security Snap Frames for **24x60 Mounted Graphics**
- Quick-Changing, all 4 frame rails snap-open for easy poster changes
- Front Loading Frame for **24x60** posters and other signage
- Snap Frame Profile: 1 1/4" Wide
- **Narrow profile offers 1" overall off the wall depth**
- **Accepts 2 Printed Thicknesses: 3/8" & 1/2"**
- Viewable Area: Moulding overlaps poster insert by 3/8" all around
- (9) Aluminum snap frame finishes available
- **1/2" Silver bottom frame rail is exposed from side view for all frame**

colors selected

- .040 Backing Board: Thin, durable backer board provides rigidity for your poster
- .020 clear PETG overlay is included to protect your poster insert
- **Allen Wrench Tool is included to remove and secure your inserts**
- SwingSnaps poster frames can mount either **Portrait or Landscape**
- Installs Easily: Punched holes in frame allow for easy surface mounting
- Wall Hanging hardware (screws) included

**EXTRA LARGE - EXTRA DEEP
Security Snap Frames 24x60 Ship UNASSEMBLED**

- Aluminum snap-open displays are for **INDOOR** or ****OUTDOOR** use

****Make sure you laminate your insert material if going outdoors**

****Poster Snap Frames are weather resistant...not water-proof**

Ships Unassembled

- ALL snap frame sizes are cut to size, and prepped for easy assembly
- Takes minutes to assemble, Corner Key and Mounting Hardware Included
- Backing Board is rolled up and placed into box for shipping cost savings
- Clear Overlay is rolled up and placed into box for shipping cost savings

- ALL snap frame rail sizes 85" and larger will be **CUT in HALF** and

provided with a Straight Joiner Key to connect the two snap frame rails together.

This will create a seam in your snap frame rail where 2 or more pieces on one side of your frame will flip open.

The main reason for creating the seam is to reduce shipping costs. We will ship these chopped snap frame rails via common carrier ground service.

Each Frame Rail that is **CUT in HALF** will receive a **CENTERED** security screw

- We will ship any Length up to 144" in **FULL LENGTH** via Freight Carrier.

Please call us for your oversized snap frame dimensions to provide frame & freight costs

For Detailed Instructions on How to Assemble click on the Instruction Sheet ICON up above.

Mounted Graphic Details

3/8" Mounted Graphic Insert
All frames will include a .040 Black Backer Board
All frames will include a .020 Clear Overlay

1/2" MAX Mounted Graphic Insert
.040 Black Backer Board **NOT INCLUDED** (can not fit)
.020 Clear Overlay **NOT INCLUDED** (can not fit)

Custom Sizes & Shipping Options Available

Model	Insert Size	Overall Size	Viewable Area	Ships Via	Shipping Wt	How is Frame Shipped?
SSMCSSXLMT-DEEP-2460	24" x 60"	25 3/4" x 61 3/4"	23 1/4" x 59 1/4"	UPS	18	Unassembled