

24 x 36 Poster Snap Frame SwingSnaps (with Security Screws)

FOR CURRENT PRICING, VISIT THE ID # LISTED ABOVE
FREE SHIPPING

Product Details

***ALL 4 FRAME SIDES HAVE A SECURITY SCREW PLACED INTO THE CENTER OF EACH FRAME RAIL. THESE SCREWS SECURE THE SAFETY OF YOUR POSTING AND PREVENT ANY TAMPERING.**

- 24x36 Poster Snap Frame, Security Style
- Allen Wrench Tool with Security Screws
- Quick-Changing, all 4 frame rails snap-open with Tool
- Holds Posters and Signs 24 x 36 Size
- Front Loading Frame for posters and other signage
- Snap Frame Profile: **1 1/4" Wide**
- Narrow profile offers an 11/16" overall off-the-wall depth
- Accepts printed material up to **1/16" thick**
- Viewable Area: Moulding overlaps poster insert by 3/8" all around
- (9) Aluminum snap frame finishes
- .040 Backing Board: provides rigidity for thin poster sheet when inside frame.
- .020 clear PETG overlay included protecting printed poster insert
- **Allen Wrench Tool** included to secure and remove screws from snap frame
- Installs Easily: Punched holes in frame for easy surface mounting
- Wall Mount Hardware and (screws) Included
- Call for Custom Snap Frame Sizes Large and Small

- Aluminum snap-open display frames for **INDOOR** or ****OUTDOOR** use

****Be sure to laminate your insert material if going outdoors**
****Poster Snap Frames are weather resistant. Not waterproof**

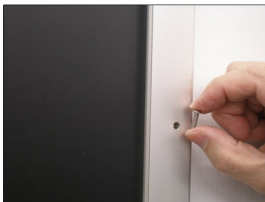
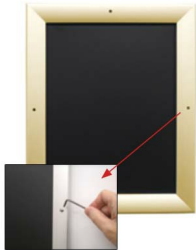

Customize your Snap Frames

- [Call to Customize Security Screw Poster Snap Frames!](#)

Model	Insert Size	Overall Size	Viewable Area	Ships Via	Shipping Wt	How is Frame Shipped?
SSMCSS-2436	24" x 36"	25 3/4" x 37 3/4"	23 1/4" x 35 1/4"	UPS	12	Unassembled