

**SwingSnaps Poster Snap Frames 24x36 (1" Wide with Mitered Corners)**

FOR CURRENT PRICING, VISIT THE ID # LISTED ABOVE  
FREE SHIPPING



**Product Details**

- 24x36 Quick-Changing, all 4 frame rails snap-open for easy poster changes
- Fits 24x36 Poster Inserts
- Front Loading Frame for 24x36 posters and other signage
- Snap Frame Profile: 1" Wide
- Narrow profile offers 1/2" overall off the wall depth
- Accepts printed material up to 1/16" thick
- Viewable Area: Moulding overlaps poster insert by 3/8" all around
- (2) Anodized Aluminum snap frame finishes available
- Thin, durable styrene backer board provides rigidity for your poster
- Anti-Reflective PETG overlay is included to protect your poster insert
- No Tools! All four frame sides snap-open easily by hand
- SwingSnap poster frames can mount either **Portrait or Landscape**
- Installs Easily: Punched holes in frame allow for easy surface mounting
- Hanging hardware is included

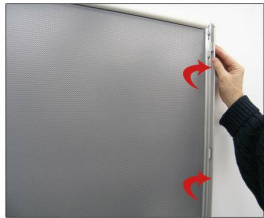

**Frames Shipped FULLY ASSEMBLED**

- Aluminum snap-open displays are for **INDOOR** or **\*\*OUTDOOR** use

\*\*Make sure you laminate your insert material if going outdoors  
\*\*Poster Snap Frames are weather resistant...not water-proof



**Minimum Order Fee**

This product has a **\$90.00** minimum order requirement (shipping charges excluded)  
A **\$15.00** charge will be applied for orders under \$90.00

Model	Insert Size	Overall Size	Viewable Area	Ships Via	Shipping Wt	How is Frame Shipped?
SSMC1-2430	24" x 30"	25.325" x 31.325"	23.325" x 29.325"	FedEx	10	Assembled