

SwingSnaps Poster Snap Frames 36x42 (1" Wide with Mitered Corners)

FOR CURRENT PRICING, VISIT THE ID # LISTED ABOVE

Product Details

- 36x42 Quick-Changing, all 4 frame rails snap-open for easy poster changes
- Fits 36x42 Poster Inserts
- Front Loading Frame for 36x42 posters and other signage
- Snap Frame Profile: 1" Wide
- Narrow profile offers 1/2" overall off the wall depth
- Accepts printed material up to 1/16" thick
- Viewable Area: Moulding overlaps poster insert by 3/8" all around
- (2) Anodized Aluminum snap frame finishes available
- Thin, durable styrene backer board provides rigidity for your poster
- Anti-Reflective PETG overlay is included to protect your poster insert
- No Tools! All four frame sides snap-open easily by hand
- SwingSnap poster frames can mount either Portrait or Landscape
- Installs Easily: Punched holes in frame allow for easy surface mounting
- Hanging hardware is included

Frames Shipped FULLY ASSEMBLED

- Aluminum snap-open displays are for **INDOOR** or ****OUTDOOR** use

****Make sure you laminate your insert material if going outdoors**
****Poster Snap Frames are weather resistant...not water-proof**

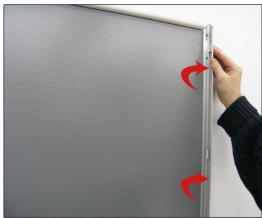

| Model | Insert Size | Overall Size | Viewable Area | Ships Via | Shipping Wt | How is Frame Shipped? |
|------------|-------------|-------------------|-------------------|-----------|-------------|-----------------------|
| SSMC1-3642 | 36" x 42" | 37.325" x 43.325" | 35.325" x 41.325" | FedEx | 18 | Assembled |