

SwingSnaps Poster Snap Frames 9x12 (1" Wide with Mitered Corners)

FOR CURRENT PRICING, VISIT THE ID # LISTED ABOVE

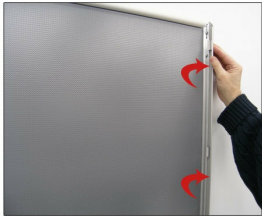

Product Details

- 9x12 Quick-Changing, all 4 frame rails snap-open for easy poster changes
- Fits 9x12 Poster Inserts
- Front Loading Frame for 9x12 posters and other signage
- Snap Frame Profile: 1" Wide
- Narrow profile offers 1/2" overall off the wall depth
- Accepts printed material up to 1/16" thick
- Viewable Area: Moulding overlaps poster insert by 3/8" all around
- (2) Anodized Aluminum snap frame finishes available
- Thin, durable styrene backer board provides rigidity for your poster
- Anti-Reflective PETG overlay is included to protect your poster insert
- No Tools! All four frame sides snap-open easily by hand
- SwingSnap poster frames can mount either Portrait or Landscape
- Installs Easily: Punched holes in frame allow for easy surface mounting
- Hanging hardware is included

Frames Shipped FULLY ASSEMBLED

- Aluminum snap-open displays are for **INDOOR** or ****OUTDOOR** use

****Make sure you laminate your insert material if going outdoors**
****Poster Snap Frames are weather resistant...not water-proof**

Minimum Order Fee

This product has a **\$75.00** minimum order requirement (shipping charges excluded)
A \$15.00 charge will be applied for orders under \$75.00

Model	Insert Size	Overall Size	Viewable Area	Ships Via	Shipping Wt	How is Frame Shipped?
SSMC1-912	9" x 12"	10.325" x 13.325"	8.325" x 11.325"	FedEx	5	Assembled