

3-IN-ROW Kiosk ECO-Design Outdoor Freestanding Information Message Boards with Literature Rack

FOR CURRENT PRICING, VISIT THE ID # LISTED ABOVE

Product Details

- Eco-Design Outdoor 3-IN-ROW KIOSK Message Center
- Literature Rack with (5) Slots Included
- 3 Panel Free Standing Information Display Board
- Faux Wood Recycled Dense Plastic Lumber
- Viewing Area: 28.25" Wide x 42" High (Two Sides)
- Viewing Area: 42" Wide x 28.25" High (Center)
- Overall Size: 132.75" Wide x 8.5" Deep x 84" High
- Four Posts 3 1/2" Square Structural-Grade Recycled Plastic
- **Extra Durable Heavy-Duty Black Rubber Tackboard**
- (3) Locking Display Cases | 2 Locks per Door with Two Keys Included
- **3 In-Line Doors - (1) Center Case BOTTOM HINGED**
- **(2) Outer Cases SIDE Hinged**
- Stainless Steel Door Hinges
- UV-Resistant non-yellowing, break resistant acrylic window
- **Eco-Friendly, Maintenance Free**
- Constructed from high density Recycled Plastic (Polyethylene) Lumber
- Faux Wood Style: Looks like Real Wood
- Will Not Rot, Splinter or Crack
- Impervious to Water, Chemicals, Insects
- Six Faux Wood Finishes
- Weather Resistant Exterior Cabinet: Not flood or waterproof
- Finished back panel adds structural integrity
- Protective Slanted Top Roof Shield
- Choose Posts: **In-Ground or Surface Mount**
- **Optional:** LED Illuminated display cases
- Call For Outdoor Custom Message Center Sizes Standing or Wall Mount

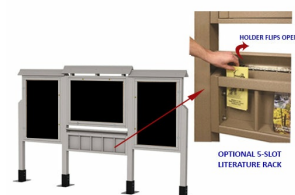

Full
Perimeter
LED Lighting



Literature Rack
(comes with 5 Slots)

Post Options

SURFACE MOUNT POSTS

If you're looking to display your message board on concrete, brick, cement or any other solid surface, this is the best option. Included are (4) Metal Base (sleeves) which accept each post with a secure snug fit. To properly install the freestanding message board, simply use the appropriate screws and anchors for the surface where you are affixing the post.

- Includes (2) 78" High x 3 1/2" Posts
- (2) 60" High x 3 1/2" Posts
- Base Plates: (4) 8" Wide x 10" Deep" x 8.5" High

IN-GROUND POSTS

When installing your display directly into ground (for example grass or dirt) , then this is the option to choose. Posts provided are longer than the surface mount posts, as a portion of the posts will be dug into the ground for added support. The overall height will remain same as surface mounted posts, for an ideal viewing height.

- Includes (2) 114" High x 3 1/2" Posts
- (2) 96" High x 3 1/2" Posts

Recycled Plastic Construction Benefits

- Maintenance Free Recycled Plastic.
- Eliminate yearly maintenance with high-quality recycled plastic outdoor display boards â€” no painting or replacing rotting boards.
- Will not crack or decay, split, peel, rot or chip
- Rustproof and graffiti resistant
- Impervious to water, chemicals, and insects
- Finished back panel looks great and adds structural integrity

Ordering Options

5-SLOT LITERATURE RACK

This optional literature holder is ideal when you have pamphlets, brochures, catalogs, maps, advertisements etc.. that you want to display and offer to the public when passing by. Comes included with a top hinged cover and acrylic shield to protect your brochures from inclement weather. The rack will match the color of your message center you select.

- Includes **Five** Slots.
- 5 Slots have a viewing area of 8.5" Wide x 10" High

LED LIGHTS - BRIGHTER & LONGER LASTING

Go GREEN with our energy saving LED Lights. Interior LED Lights are positioned on the interior to spotlight your posters, signage, postings, menus, and other printed announcements. LED lights are long lasting, and energy efficient.

INSIDE PERIMETER (ALL 4 SIDES)

For this option we install LED strip lighting along the entire Perimeter of the interior message center. The light will shine from all 4 sides of the interior case, bringing more light intensity to the contents being displayed inside.

- Pre-cut 1/2" dia. LED light roping is factory-installed
- Pre-assembled SJT (Heavy-duty) power cord with rectifier & 2-prong polarized plug requires a power source
- Power cord exits out the bottom of the message center
- 1" vertical LED bulb spacing
- Temperature Rating: -60Â°~â°žF - 200Â°~â°žF
- Light Color: Warm white
- Brightness: 6500
- Dimmable
- 100,000 hours of burn time
- Energy efficient - only consumes 0.8 watts per foot
- 120 volts (No transformer required)
- Indoor/ outdoor use.

Model	Overall Size	Viewable Area Side Boards	Viewable Area Center Board	Hinge Location	Shipping Weight (With Posts)
EDK-117	132.75" w x 8.5" d x 84" h	28.25" w x 42" h (2)	42" w x 28.25" h (1)	Left and Bottom Hinged	436 LBS