

### Outdoor Premium Weatherproof Magnetic White Notice Board | Holds (9) 8.5x11 Graphics | Silver Finish

FOR CURRENT PRICING, VISIT THE ID # LISTED ABOVE

#### Product Details

- Weatherproof Message Board
- Enclosed Magnetic Whiteboard Display Frame
- Outdoor Premium Weatherproof Magnetic Notice Boards
- Magnetic Whiteboard Case Displays up to (9) 8.5x11 inserts
- 9 Front Lock Secures the Magnetic White Board Cabinet
- **Weatherproof Notice Board Display Case**
- Aluminum Frame Construction
- Satin Silver Frame
- Wall Display Frame for Notices, Postings, Posters, Signs, Photography, Etc.
- **Modern Beveled Safety Edge Frame Design with Mitered Corners**
- Swing Open Hinged Frame
- 2 Prop Arms - Mechanism Easily Hold Front Frame Door Open
- Interior Frame Designed to Seal From Wet Weather
- Helps protect printed insert
- Interior Magnetic White Backing Board
- Wall Mount Frame in either Portrait or Landscape Position
- Magnet Board Area: 28" x 38.31"
- Overall Frame Size: 32.28" x 42.52"
- Frame Profile Width: 2 13/16"
- Overall Case Depth: 2"
- FREE Set of Magnets are Included
- **Includes Protective Polycarbonate Window Lens**
- Easy to follow instruction sheet
- Please do not drill the product while mounting, only use the mounting arms.
- Comes with protective film to be discarded before use
- Magnetic White Board **Quick Ships Ground within 1-2 Days**

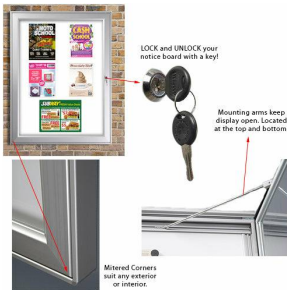

Model	Insert (Viewable Area)	Magnet Board Area	Overall Size
TKM770	Displays (9) 8.5x11 Inserts	28" x 38.31"	32.28" x 42.52"