

Extra Large Poster Snap Frame 36x96 with Security Screws for MOUNTED GRAPHICS | Holds 1/8", 3/16",  
and 1 1/4" Thick Boards

FOR CURRENT PRICING, VISIT THE ID # LISTED ABOVE  
FREE SHIPPING

Product Details

**\*ALL 4 FRAME SIDES HAVE A SECURITY SCREW PLACED INTO THE CENTER OF EACH FRAME RAIL. THESE SCREWS SECURE THE SAFETY OF YOUR POSTING AND PREVENT ANY TAMPERING.**

- X Large Security Snap Frames for Mounted Graphics
- For 36x96 Posters and Signs on Rigid Boards
- Accepts 1/8, 3/16", 1/4" Thick Boards
- Allen Wrench Tool with Security Screws Included
- Quick-Changing, all 4 frame rails snap-open with Tool
- Front Loading Frame for posters and other signage
- Snap Frame Profile: **1 1/4" Wide**
- Narrow profile offers an 11/16" overall off-the-wall depth
- Accepts printed material up to 1/4" thick
- Viewable Area: Moulding overlaps poster insert by 3/8" all around
- (9) Aluminum snap frame finishes
- .040 Backing Board: If needed, provides rigidity for a thin poster board
- .020 clear PETG overlay included protecting poster insert
- **Allen Wrench Tool** included to remove and secure your inserts
- SwingSnap poster frames mount Portrait or Landscape
- Installs Easily: Punched holes in frame for easy surface mounting
- Wall Mount Hardware (screws) Included
- Call for Custom Snap Frame Sizes Large and Small

**XL Security Snap Frame 36x96 Ship UNASSEMBLED**

- Aluminum snap-open displays are for **INDOOR** or **\*\*OUTDOOR** use

**\*\*Be sure to laminate your insert material if going outdoors**  
**\*\*Poster Snap Frames are weather resistant, not waterproof**  
**XL Security Snap Frame 48x48 Ship UNASSEMBLED**

Ships Unassembled

- ALL snap frame sizes are cut to size, and prepped for easy assembly
- Takes minutes to assemble, Corner Key and Mounting Hardware Included
- Backing Board is rolled up and placed into box for shipping cost savings
- Clear Overlay is rolled up and placed into box for shipping cost savings

- ALL snap frame rail sizes 85" and larger will be CUT in HALF and

provided with a Straight Joiner Key to connect the two snap frame rails together.

This will create a seam in your snap frame rail where 2 or more pieces on one side of your frame will flip open.

The main reason for creating the seam is to reduce shipping costs.  
We will ship these chopped snap frame rails via common carrier ground service.

Each Frame Rail that is CUT in HALF will receive a CENTERED security screw

- We will ship any Length up to 144" in FULL LENGTH via Freight Carrier.

Please call us for your oversized snap frame dimensions to provide frame & freight costs

For Detailed Instructions on How to Assemble click  
on the Instruction Sheet ICON up above.

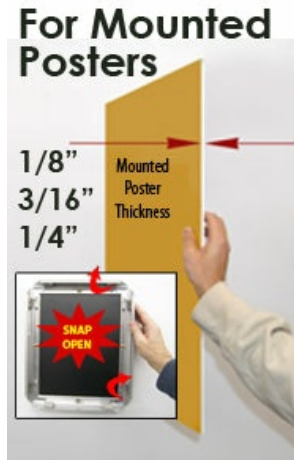
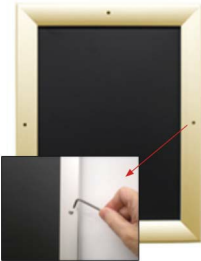

Mounted Graphic Details

1/8" Mounted Graphic Insert  
All frames will include a .040 Black Backer Board  
All frames will include a .020 Clear Overlay

3/16" Mounted Graphic Insert  
All frames will include a .040 Black Backer Board  
All frames will include a .020 Clear Overlay

1/4" MAX Mounted Graphic Insert  
.040 Black Backer Board **NOT INCLUDED** (can not fit)  
.020 Clear Overlay **NOT INCLUDED** (can not fit)

Custom Sizes & Shipping Options Available

- **Call to Customize XL Mounted Poster Tamper Proof 36x96 Frames!**
- If you request a Snap Frame to be FULLY ASSEMBLED, please call for a shipping quote.
- Call us to quote out snap frames sizes up to 144" x 144" (12 FEET x 12 FEET)

[About SwingSnap Snap Frames:](#)

[Easy Assembly Instructions:](#)

Model	Insert Size	Overall Size	Viewable Area	Ships Via	Shipping Wt	How is Frame Shipped?
SSMCSSXLMT-3696	36" x 96"	37 3/4" x 97 3/4"	35 1/4" x 95 1/4"	UPS	34	Unassembled